

Qty.	Description
1	<p>UPS2 32-80 180</p>  <p>Note! Product picture may differ from actual product</p> <p>Product No.: 98707851</p> <p>High-efficiency circulator pump with permanent-magnet motor (ECM technology) fit for the ErP directive No 641/2009 due to continuously variable speed control for circulation of clean heating water according to VDI 2035.</p> <p>Features and benefits: UPS2 32-80 180</p> <p>High-efficiency circulator pump with permanent-magnet motor (ECM technology) complying with the ErP directive No 641/2009 thanks to continuously variable speed control. Suitable for circulation of clean heating water according to VDI 2035.</p> <p>Features and benefits:</p> <ul style="list-style-type: none"> • Complying with requirements of the ErP directive as from 2015. • 1 pump replaces 3 variants. • It is available as pump head without pump housing. Fits on all 4-m, 5-m and 6-m pump housings of the Series 100. • For tight installations, i.e. in boiler applications. • High energy savings thanks to an energy efficiency index (EEI) lower than 0.23. • Complies with the German regulation on energy saving in buildings and building systems – Energieeinsparverordnung – EnEV §14(3). • One button for simple selection among three proportional-pressure curves or three fixed speeds. • No corrosion issues thanks to the electrocoated pump housing. • Reduced installation costs as no external motor protection is required. <p>Liquid:</p> <p>Pumped liquid: Water</p> <p>Liquid temperature range: 2 .. 95 °C</p> <p>Selected liquid temperature: 60 °C</p> <p>Density at selected liquid temperature: 983.2 kg/m³</p> <p>Technical:</p> <p>TF class: 95</p> <p>Approvals on nameplate: CE, WEEE</p> <p>Materials:</p> <p>Pump housing: Cast iron EN-JL1020 ASTM A48-25B</p> <p>Impeller: Composite, PES/PP</p> <p>Installation:</p> <p>Maximum operating pressure: 10 bar</p> <p>Pipe connection: G 2</p> <p>Pressure rating: PN 10</p> <p>Port-to-port length: 180 mm</p>



Company name:

Created by:

Phone:

Date:

25/09/2019

Qty.	Description
	Electrical data: Power input - P1: 140 W Mains frequency: 50 Hz Rated voltage: 1 x 230 V Maximum current consumption: 0.1 .. 1.1 A Enclosure class (IEC 34-5): X2D Insulation class (IEC 85): F

98707851 UPS2 32-80 180 50 Hz

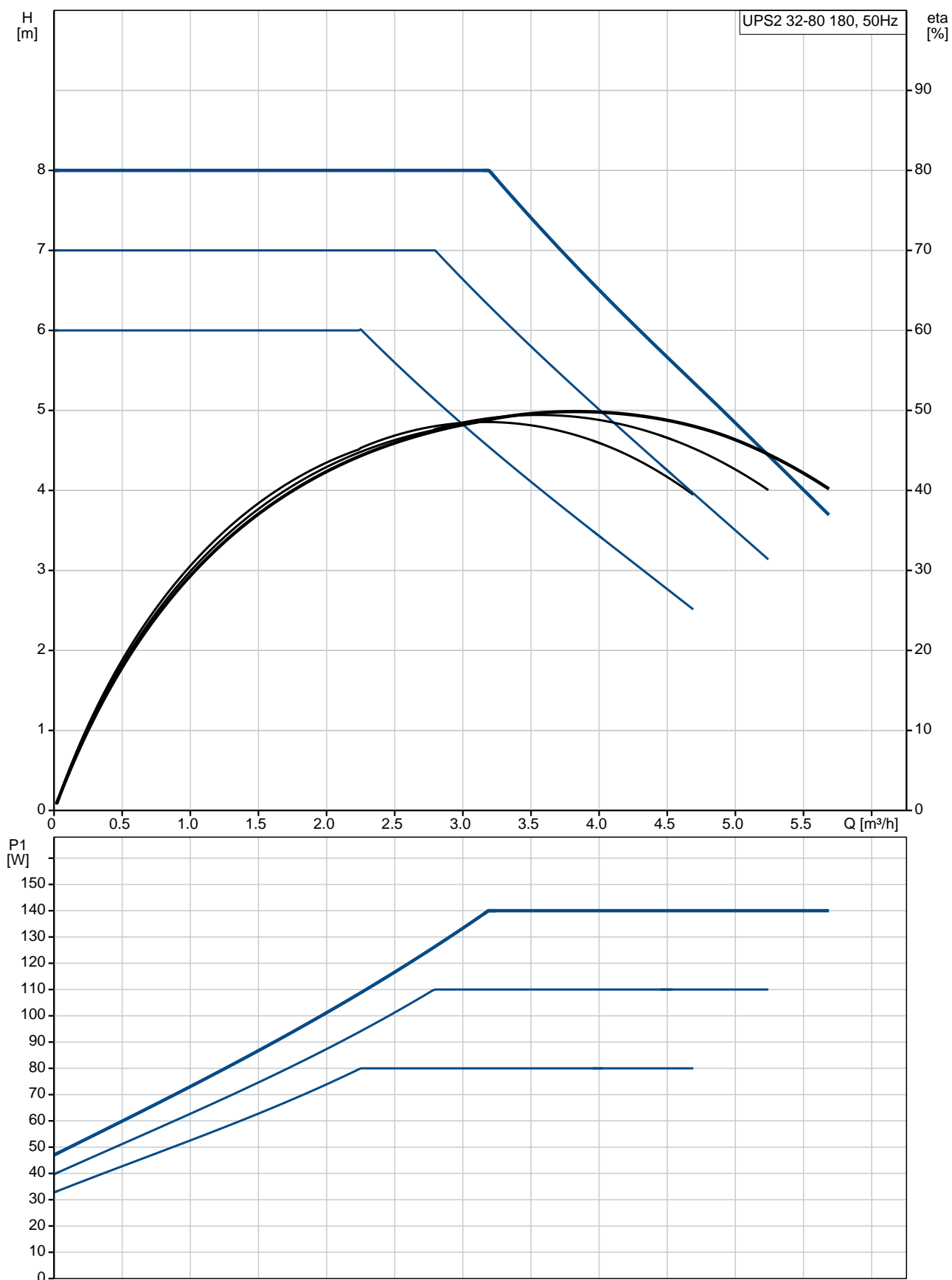

Description	Value
General information:	
Product name:	UPS2 32-80 180
Product No:	98707851
EAN number:	5712600251885
	5712600251885
Technical:	
Head max:	80 dm
TF class:	95
Approvals on nameplate:	CE, WEEE
Materials:	
Pump housing:	Cast iron
	EN-JL1020
	ASTM A48-25B
Impeller:	Composite, PES/PP
Installation:	
Maximum operating pressure:	10 bar
Pipe connection:	G 2
Pressure rating:	PN 10
Port-to-port length:	180 mm
Liquid:	
Pumped liquid:	Water
Liquid temperature range:	2 .. 95 °C
Selected liquid temperature:	60 °C
Density at selected liquid temperature:	983.2 kg/m ³
Electrical data:	
Power input - P1:	140 W
Mains frequency:	50 Hz
Rated voltage:	1 x 230 V
Maximum current consumption:	0.1 .. 1.1 A
Enclosure class (IEC 34-5):	X2D
Insulation class (IEC 85):	F
Motor protec:	NONE
Thermal protec:	ELEC
Controls:	
Pos term box:	9H
Others:	
Energy (EEI):	0.23
Net weight:	2.86 kg
Gross weight:	2.86 kg
Shipping volume:	0.005 m ³
Sales region:	GB
Country of origin:	RS
Custom tariff no.:	84137030

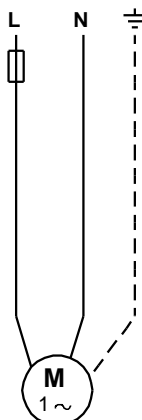
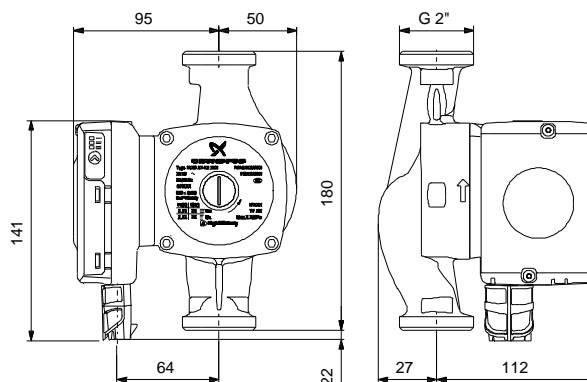
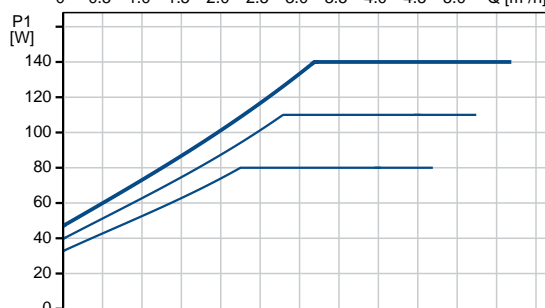
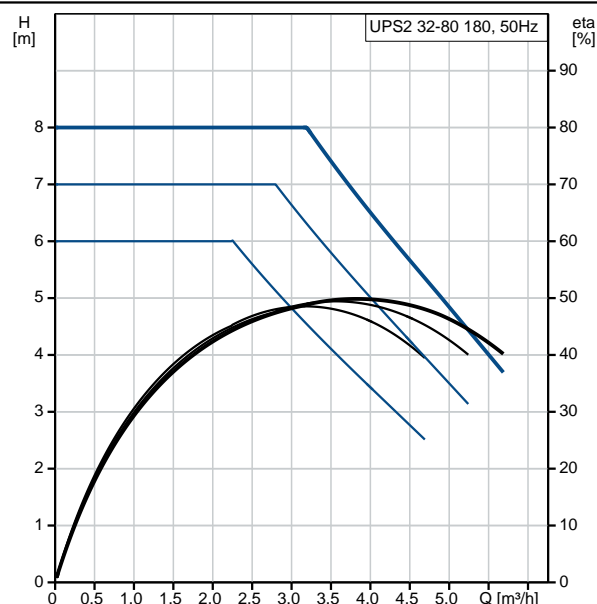

98707851 UPS2 32-80 180 50 Hz

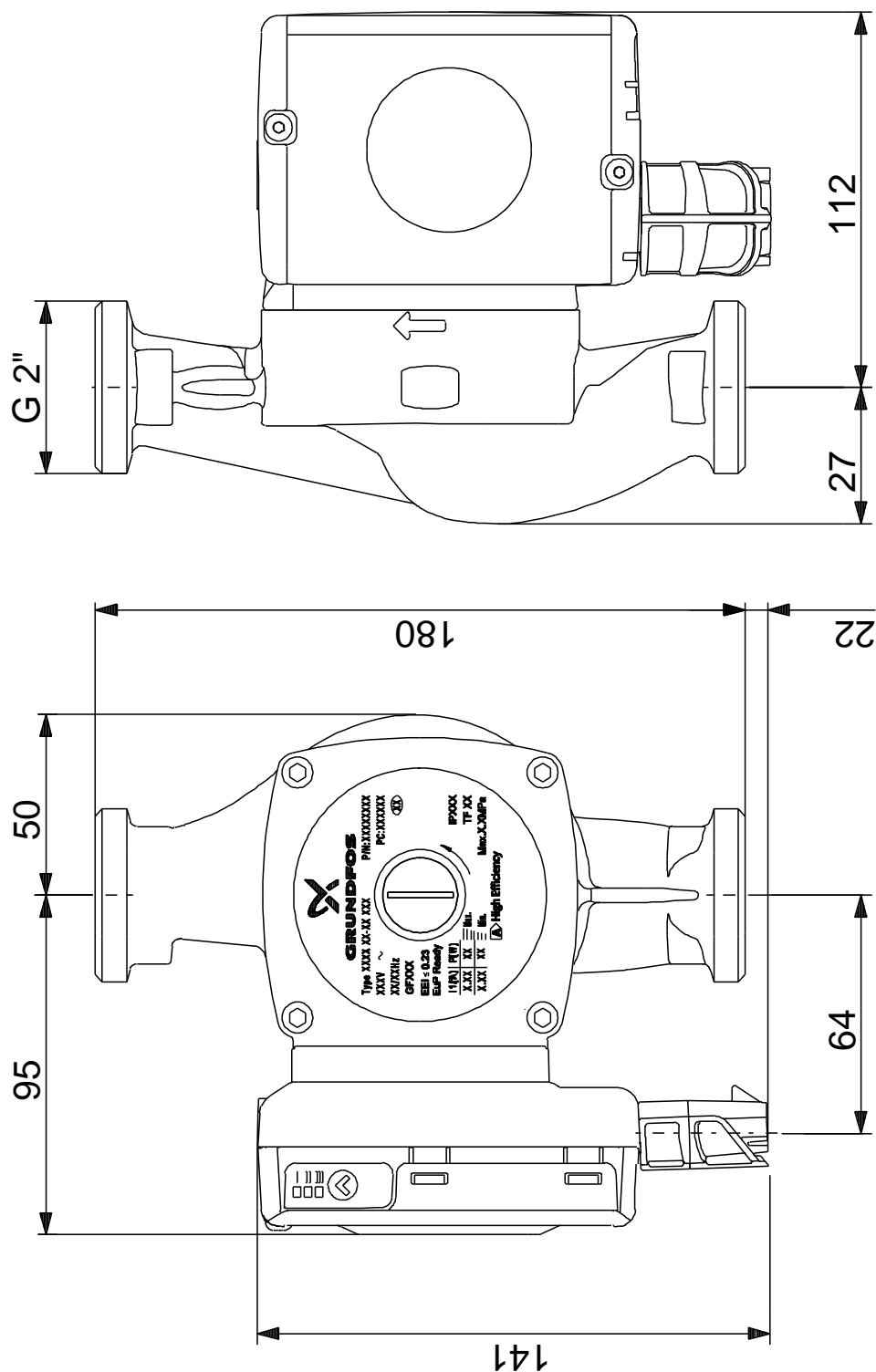

Note! All units are in [mm] unless others are stated.

Disclaimer: This simplified dimensional drawing does not show all details.